

MBE

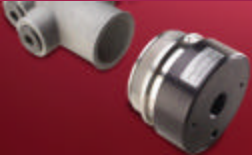

MBE



FIG



FIH



WEH 60



WEH 70



WEH 850



WEH 130

Product Selector Guide for Custom Connections

Click connector for more information

Description

MBE connectors make reliable, leak tight connections on expanded tubes. Designed for high flow run testing. Also ideal for helium leak testing, proof testing, pressure decay and other related processes. The sliding sleeve locks when pressurized to make safe, secure instant connections with no operator adjustment.

For more details [click here](#)

Pressure range

Vacuum to
625 psi

Operation style

Size Range

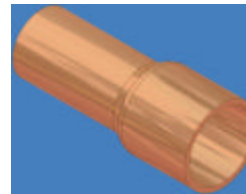

Expanded
5/16" to 1 1/8" ID

FIG



MBE



FIG



FIH



WEH 60



WEH 70



WEH 850



WEH 130

Product Selector Guide for Custom Connections

Click connector for more information

Description

For gripping and sealing rough case and out of round ports with a bead, which are common on intake manifolds. The FIG mechanically grips to an external bead. The pneumatically operated elastomer compresses into the ID to provide leak tight connection. Ideal for applications when fixturing a standard FI is not practical or desirable. Designed specifically to your size and requirements for up to 4 inches. For vacuum or pressure applications up to 120psi.

[For more details click here](#)

Pressure range

Vacuum to
120 psi

Operation style

Pneumatic operation

Size Range

Designed specifically to your size and requirements up to 4 inches

FIH



MBE

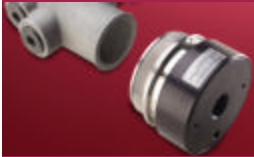

FIG



FIH



WEH 60



WEH 70



WEH 850



WEH 130

Product Selector Guide for Custom Connections

Click connector for more information

Description

For sealing flexible hoses. The FIH utilizing a shroud designed to restrict the expansion of common flexible hoses such as coolant, vacuum and fuel hoses. Shroud provides support to the external surface of the hose as an elastomer is expanded into the ID for a leak tight connection. Designed specifically to your size and requirements for up to 3 inches. For vacuum or pressure applications up to 120psi.

[For more details click here](#)

Pressure range

Vacuum to
120 psi

Operation style

Pneumatic operation

Size Range



Designed specifically to your size requirements in hoses up to 3 inches

WEH 60



MBE



FIG



FIH



WEH 60



WEH 70



WEH 850



WEH 130

Product Selector Guide for Custom Connections

Click connector for more information

Description

The sleeve-action, collet-locking design of Weh 60 compact connectors make instant leak tight connections to male threaded ends commonly found on tube and hose assemblies. Designed for helium leak testing, run testing, proof testing, pressure decay, water dunk and other related processes. Works well in confined areas and needs no operator adjustment. Standard sizes available. Custom applications can include an internal valve, a safety sleeve lock and other features as required by your specific application.

For more details click here

Pressure range

Vacuum to 750 psi

Operation style

Manual sleeve

Size Range

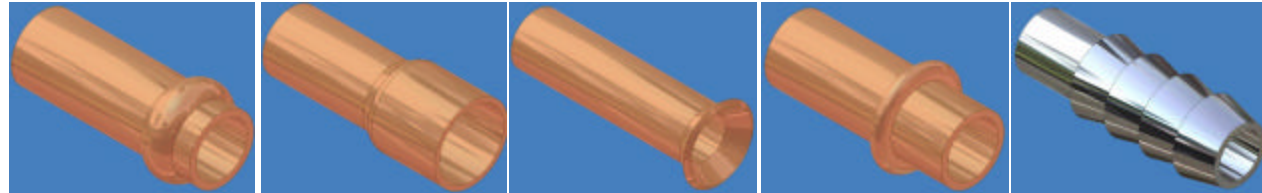

Formed End .236" to 2.040" OD
 Expanded .236" to 2.040" OD
 Flared .236" to 2.040" OD
 Beaded .236" to 2.040" OD
 Barbed .236" to 2.040" OD

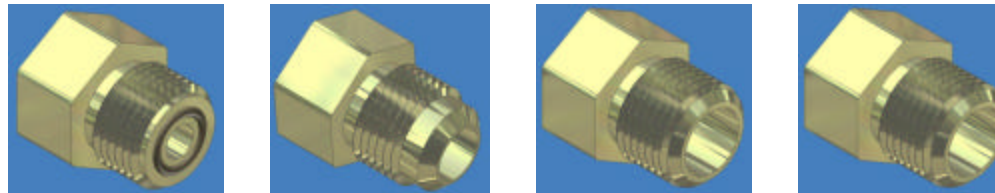

O-Ring Face Seal 9/16"-18 to 13/16"-16
 45° Flare 7/16"-20 to 1 3/8"-12
 37° Flare 7/16"-20 to 1 5/16"-12
 NPTF 1/8 to 1"

WEH 70



MBE



FIG



FIH



WEH 60



WEH 70



WEH 850



WEH 130

Product Selector Guide for Custom Connections

Click connector for more information

Description

The sleeve-action, collet-locking design of Weh 70 compact connectors make instant leak tight connections to formed tube ends such as beads and barbs found on tube assemblies, reservoirs and cast parts. Designed for helium leak testing, run testing, proof testing, pressure decay, water dunk and other related processes. Works well in confined areas and needs no operator adjustment. Standard sizes available. Custom applications can include an internal valve, a safety sleeve lock and other features as required by your specific application.

[For more details click here](#)

Pressure range

Vacuum to 5,000 psi

Operation style

Manual sleeve

Size Range

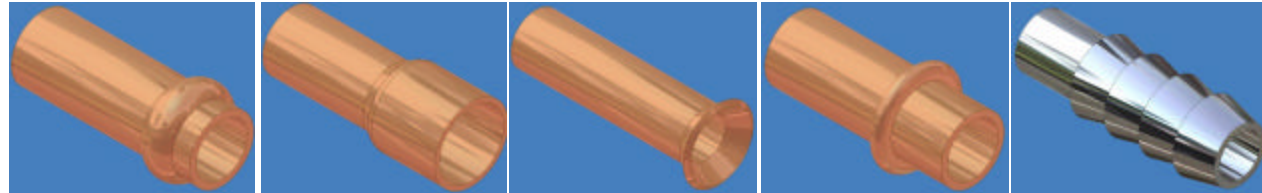

Formed End	Expanded	Flared	Beaded	Barbed
.236" to 2.040" OD	.236" to 2.040" OD	.236" to 2.040" OD	.236" to 2.040" OD	.236" to 2.040" OD

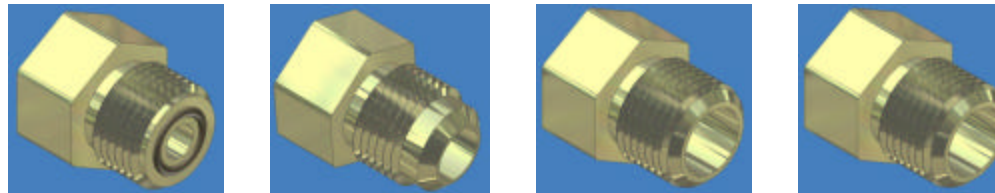

O-Ring Face Seal 9/16"-18 to 13/16"-16	45° Flare 7/16"-20 to 1 3/8"-12	37° Flare 7/16"-20 to 1 5/16"-12	NPTF 1/8 to 1"
---	---------------------------------------	--	-------------------

WEH 850



MBE

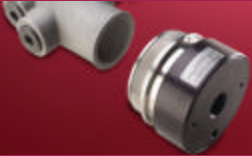

FIG



FIH



WEH 60



WEH 70



WEH 850



WEH 130

Product Selector Guide for Custom Connections

Click connector for more information

Description

Weh 850 series compact connectors have a sleeve action, collet locking design that uses a feature of the mating part, such as a shape or thread gripping at pressures up to 5000 psi. Designed for helium leak testing, run testing, proof testing, pressure decay, water dunk and other related processes. Works well in confined areas and needs no operator adjustment. Generally applied best in confined areas when ergonomic sleeve action is the preferred method of operation or for custom requirements. Custom applications can include an internal valve, a safety sleeve lock and other features as required by your specific application.

[For more details click here](#)

Pressure range

Vacuum to 1500 psi

Operation style

Manual squeeze lever

Size Range

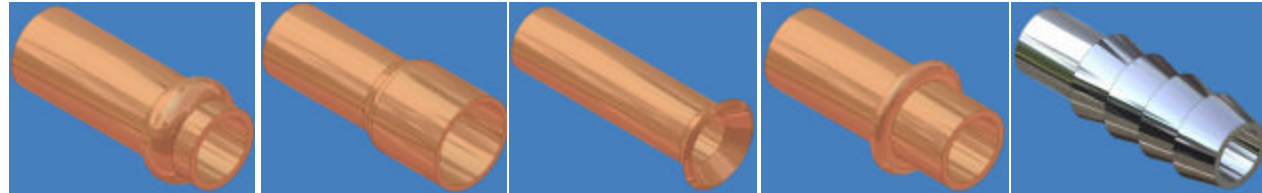

Formed End	Expanded	Flared	Beaded	Barbed
.236" to 2.040" OD	.236" to 2.040" OD	.236" to 2.040" OD	.236" to 2.040" OD	.236" to 2.040" OD

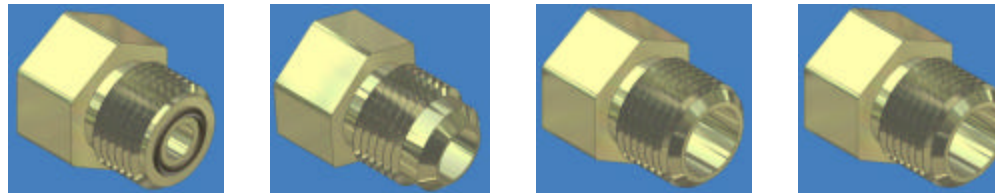

O-Ring Face Seal 9/16"-18 to 13/16"-16	45° Flare 7/16"-20 to 1 3/8"-12	37° Flare 7/16"-20 to 1 5/16"-12	NPTF 1/8 to 1"
---	---------------------------------------	--	-------------------

WEH 130



MBE

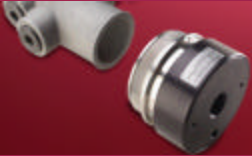

FIG



FIH



WEH 60



WEH 70



WEH 850



WEH 130

Product Selector Guide for Custom Connections

Click connector for more information

Description

Pneumatic operation for testing hose or tube assemblies with a fitting or flange similar to banjo tube connections, hose connections with sleeve nut, AC connections with a bead or flange and similar configurations. Can be automated and made available for multiple station testing. Provides a safe secure instant connection with no operator adjustment. Designed specifically to your size and requirement. Pressure range from vacuum to 5250 psi.

[For more details click here](#)

Pressure range

Vacuum to 5250 psi

Operation style

Pneumatic operation can be automated and made available for multiple station testing

Size Range

Designed specifically to your size requirements. For testing hoses and tubular assemblies with banjo tube connections, hose connections with sleeve nut and other configurations.