

Operating Instructions

1. Recommended Use:

The FasTest Adapter and G580 connector are to be used as a system to enable filling standard and RPV CGA 580 valves (including SMARTOP), and NF type C valves (including EXELTOP) – all on the same fill rack.

A few of these connection configurations are shown to the right:



G5800419CRP with CGA 580 valve, with or without RPV.

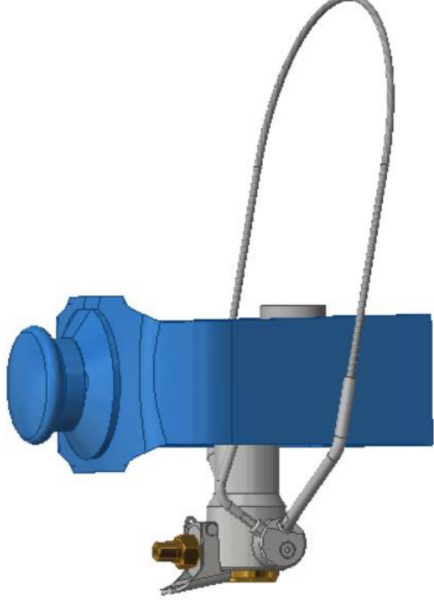

G5800419CRP with CGA 580 SMARTOP.

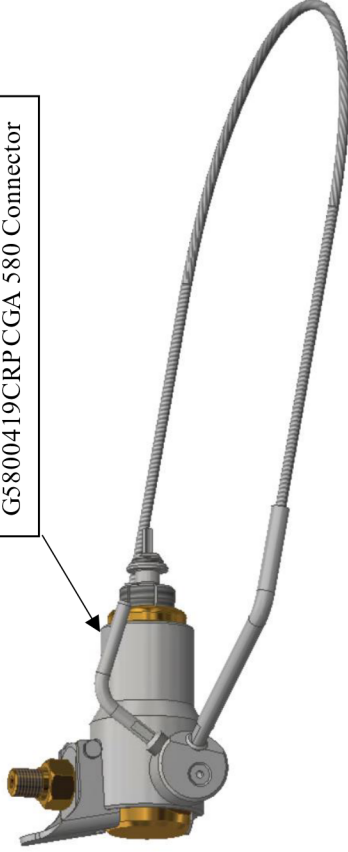

G5800419CRP CGA 580 Connector

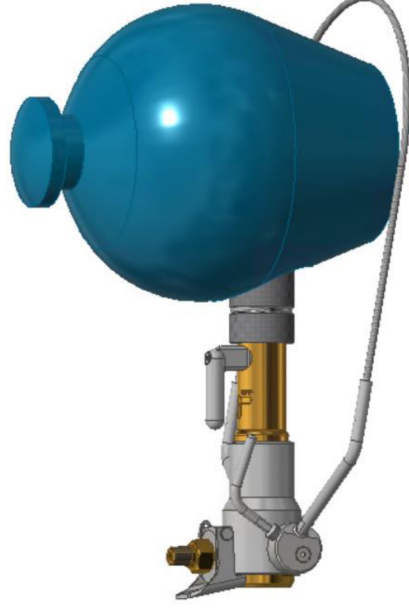

G5800419CRP with Adapter connected to NF type C EXELTOP.

GANFC580SAP NF type C to CGA 580 Adapter.

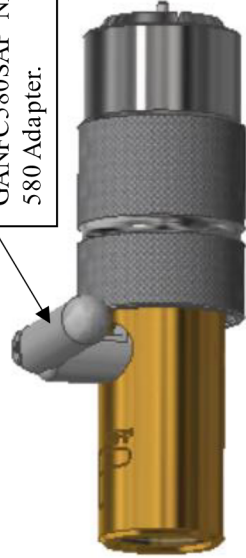

2. Use of G5800419CRP CGA 580 Connector:

- 2.1. This connector is to be used to connect to valves in accordance with the CGA 580 specifications.
- 2.2. To open the cable bail in preparation for connection, push in latch and pull lever or cable bail up approximately 90 degrees so that the collets collapse.
- 2.3. Push connector into valve (or adapter, if required) until the brass front sleeve is contacted and pushed in approximately 1/8" (3mm).
- 2.4. Close the bail by letting go of lever and allowing bail to drop around base of valve and rest on cylinder.
- 2.5. Make sure indicator line is under outer sleeve when connected properly.
- 2.6. Begin vent, vacuum, and fill process per your company's specifications.
- 2.7. Once filling is complete, be sure to close all cylinder valves and vent manifold.
- 2.8. Remove connector by pushing in latch and pulling lever or cable bail up until it is possible to remove connector from valve.
- 2.9. To use the RPV pin feature, make sure pin is in the "out" position and extends past the front of the piston by approximately half an inch (12 mm) for use with RPV valves.
- 2.10. To change between RPV pin "out" and RPV pin "in", depress pin and turn 90 degrees. Pin should stay locked into the "in" position and extend approximately 3/16" (5mm) for use with non-RPV valves.
- 2.11. For further information and detailed operating instructions on bail handle style connectors, please see WP075.

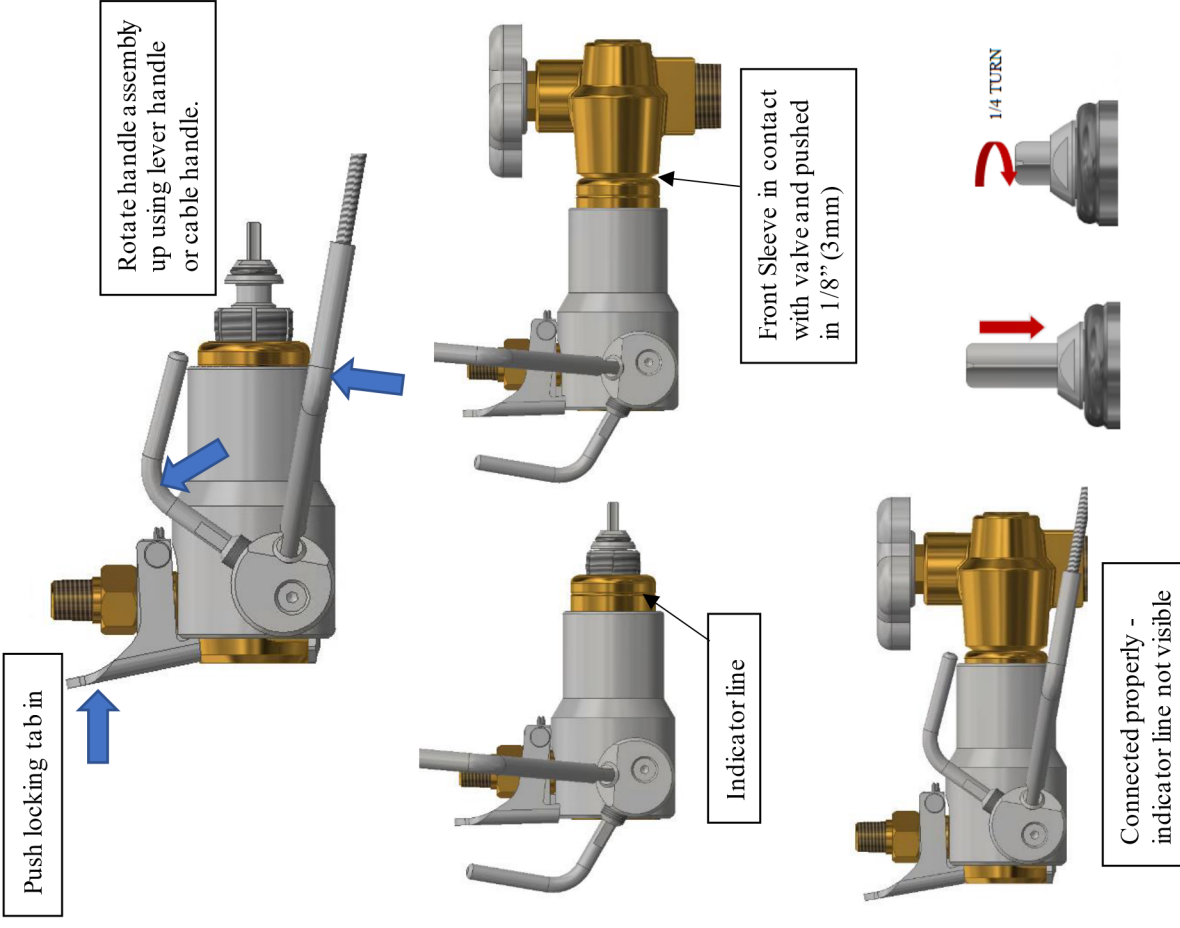

3. Use of GANFC580SAP Adapter:

- 3.1. This adapter is to be used to connect to valves in accordance with the NF type C specifications, and to be connected to a fitting or quick connector with CGA 580 specifications. It includes a manual lever actuated RPV pin for use with valve designs that allow full cylinder pressure access with RPV actuation.
- 3.2. To make the connection to the valve, make sure RPV pin handle is rotated to "OFF" position and sleeve is pulled back.
- 3.3. Align and push connector into valve holding onto the outer sleeve until the outer sleeve slides over the collets adapter is locked onto valve.
- 3.4. **Make all adapter connections to valves AND all CGA 580 connections to the adapters on full rack BEFORE actuating RPV pin handle to "ON"**.
- 3.5. Rotate the RPV pin handle to "ON" by turning 90 degrees. Pull slightly up to lock the handle into detent.
- 3.6. Begin vent, vacuum, and fill process per your company's specifications.
- 3.7. Once filling is complete, cylinder valves have been closed, retract the RPV pin by slightly pushing down on handle and rotating 90 degrees to "OFF" position. This will prevent access to full cylinder pressure and allow removal of connector and adapter. **Make sure to turn ALL adapters to "OFF" position on full rack before venting manifold or removing connectors or adapters.**
- 3.8. Vent manifold pressure and remove G580 connection and finally remove adapter by pulling back on outer sleeve.

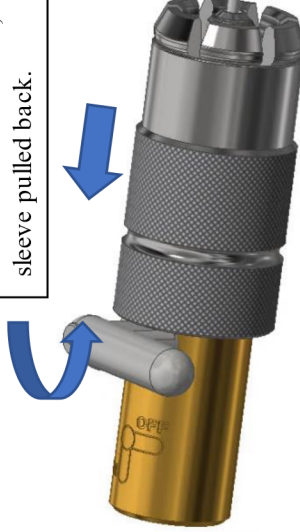

Rotate handle to "OFF", sleeve pulled back.

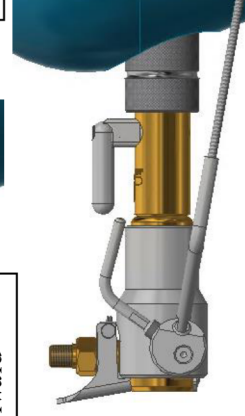
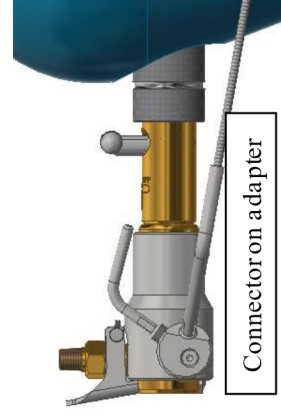
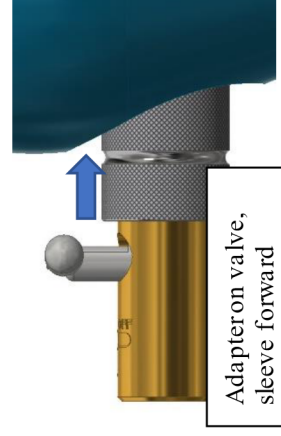

4. Maintenance:

- 4.1. In addition to these suggested maintenance guidelines, your companies overall safety and maintenance requirements should be applied to FasTest gas connector products.
- 4.2. Adhering to a consistent product maintenance program will minimize product returns for inspection as well as required maintenance costs.
- 4.3. Minimize the use of soap solutions sprayed directly onto connector and adapter. These types of solutions cause a build-up that can hamper proper connector operation. Also, avoid contacting connector with any petroleum base chemicals that can cause product contamination.
- 4.4. **DO NOT EXCEED THE MAXIMUM OPERATING PRESSURE AS STATED IN BOTH PRODUCT LITERATURE AND ON ALL INDIVIDUAL CONNECTOR PRODUCTS SOLD BY FASTEST.**

4.5. Maintenance Checklist

4.5.1.1. Daily:

Inspect for Leak-tight seal - The main seal must be replaced more frequently depending on wear. Dismantling of the connector for this purpose is not required. It is recommended that an O-ring pick be used for removal to avoid damage to the groove. Clean groove if required and insert new O-ring.

Inspect for correct function - Does the safety pin properly protrude and lock the connector under pressure? Does the safety pin move backwards when the system is depressurized?

4.5.1.2. Weekly:

Inspect for correct function - Inspect the correct engagement of the collets. Check the connector's collet thread with gauge. Check for any bent or missing components.

4.5.1.3. Periodic:

Inspect that all threaded components are tight and properly torqued. Check for any bent or missing components. Check for proper actuation of handle, collets and all moving components. Check for leaks.

4.6. Field replacement parts:

For:	Part Number:	Material:	Description:
G5800419CRP	SG580RPV*	EPDM	Replacement main seals, qty 5
GANFC580SAP	SGANFC*	EPDM	Replacement main seals, qty 5
G5800419CRP	G580RPVP	Monel	Replacement RPV pin, qty 5
G5800419CRP	CS036023014317SG	SST	Replacement RPV spring, qty 1
G5800419CRP	G5XSPK	SST, EPDM	Stop pin replacement kit, qty 1

* Replacement seals also available in quantities of 100, 250 and 500. Example: SG580RPV100 = 100 seals