

ME / MEDICAL-LIFE SCIENCES SEALING CONNECTION TOOL

Pneumatic external sealing of medical devices in automated and semi-automated processes.

CONNECTS TO:

Catheters



Luers



SPECIFICATIONS

Pressure Rating	Pilot Pressure	Operating Temperatures**
Vacuum to 500 psi (34 bar)	60-90 psi (4.1-6.2 bar)	0°F to +200°F (-17°C to +93°C)
Termination Port	Materials of	Seal Material*
1/8 FNPT	Anodized Aluminum	ME001: FDA approved FKM ME01: FDA White Neoprene*

* Additional seal material types available, consult factory.

** Operating Temp: 32°F-100°F (0°C-38°C) for ICON™

i Pilot pressure required.

All parts are washed in an aqueous solution utilizing ultrasonic agitation at a temperature of 140°F. Components are then rinsed in a cascading rinse tank and dried using 99.999% pure nitrogen and assembled in a 100,000ppm level controlled environment.

Krytox is the standard lubricant.

White FDA Neoprene seal material is compliant to 21CFR177.2600. Optional material is a FDA listed fluorocarbon..

- 1** Connector and test part should be rigidly fixtured to prevent separation when under pressure
- 2** Ideally designed for automated processes and high volume production testing
- 3** Seals against standard luers, catheter, tubes and other cylindrical components
- 4** Cleaned and lubricated for oxygen safe environment with FDA approved seals
- 5** Quick and easy seal replacement to minimize down time, maintenance and tool inventory

ACTUATION METHOD

Pneumatic: pilot pressure applied to seals with no metal contact and uniform seal movement seals inside luer

ICON™ TECHNOLOGY

 SURE SEAL™

 SEAL LIFE™

ACCESSORIES

See p. 105



ICON™

INTELLIGENT CONNECTION TECHNOLOGY

FasTest's ICON™ adds sensing capabilities to our mechanical Sealing Connection Tools. ICON™ Tools include instant LED visual feedback and data output to improve sealing connection accuracy, maximize production efficiency, and optimize maintenance.



ICON™ features:



SURE SEAL™

Instant LED feedback verifies a good connection prior to starting a test.



SEAL LIFE™

Alert when the main seal is at end of life and must be replaced.

How To Add ICON™ to ME

Signal Output	Part Number Suffix	Example
ME without ICON™	None	ME01
ME with ICON™; Analog Output Signal	CV04ANA	ME01CV04ANA
ME with ICON™; Solid State Relay	CV04SSR	ME01CV04SSR

System Overview:

CONNECTED

Green indication of a good connection.

RECONNECT

Recognize a connection issue before causing a false failure.

WORN SEAL

Alert when main seals should be replaced.

PICK TOOL

Controllable LED signals operator to use specific tool.

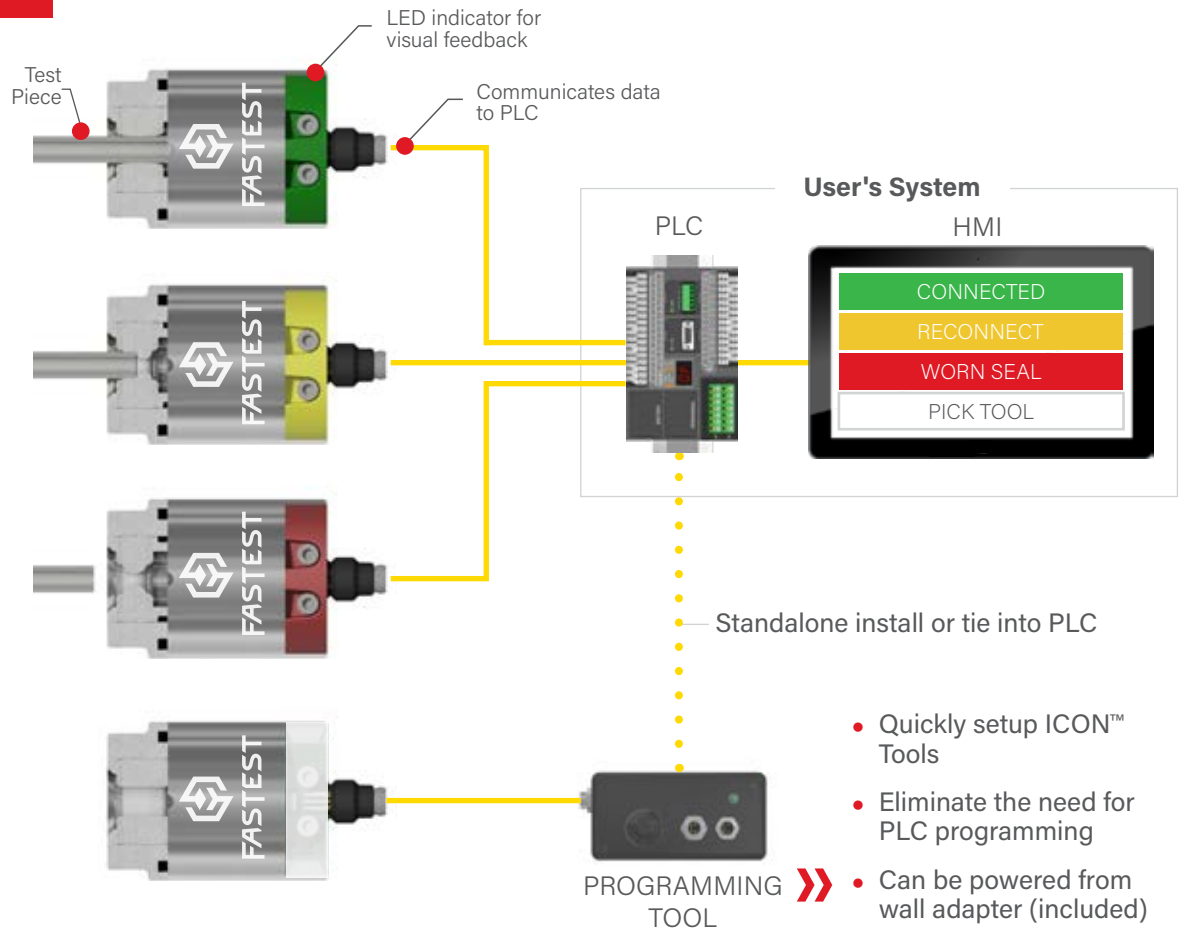

ME / MEDICAL-LIFE SCIENCES SEALING CONNECTION TOOL

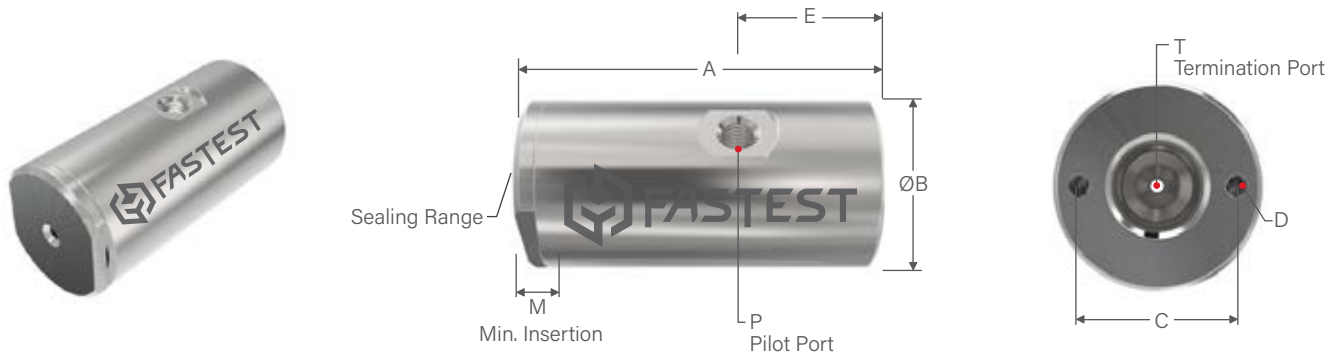

Ordering Information				Dimensions							
Sealing Range	Part Number	Replacement Seals Pack (5)	Rebuild Kit	A	B	C	D	E	M	P	T

ME | Imperial Mounting Holes and Pilot Ports

0.015 to 0.030 (0.38 to 0.80)	ME0010030	MEB0010030	MER001	1.72 (43.7)	0.84 (21.3)	0.63 (16.0)	4-40 UNC	0.72 (18.3)	0.16 (4.1)	10-32 UNF	1/8 NPT
0.030 to 0.050 (0.80 to 1.30)	ME0010050	MEB0010050									
0.050 to 0.080 (1.30 to 2.00)	ME001001	MEB001001									
0.080 to 0.130 (2.00 to 3.30)	ME001002	MEB001002									

ME | Metric Mounting Holes and Pilot Ports

0.015 to 0.030 (0.38 to 0.80)	MEM0010030	MEB0010030	MER001	1.72 (43.7)	0.84 (21.3)	0.63 (16.0)	M2.5	0.72 (18.3)	0.16 (4.1)	M5	1/8 BSPP (G)
0.030 to 0.050 (0.80 to 1.30)	MEM0010050	MEB000050									
0.050 to 0.080 (1.30 to 2.00)	MEM001001	MEB001001									
0.080 to 0.130 (2.00 to 3.30)	MEM001002	MEB001002									

Dimensions: inch (mm)



*Dimension only applies to ME with ICON™ Technology (Base Part Numbers that include "CV04ANA" or "CV04SSR").

Ordering Information (Complete Connector = Main Seal Set + Base Part Number)					Dimensions						
Sealing Range	Main Seal Set*	Base Connector Part Number	Replacement Seals Package (5)	Rebuild Kit	A	B	C	D	M	P	T

ME | Imperial Mounting Holes and Pilot Ports

0.100 to 0.180 (2.5 to 4.6)	MES0101	ME01 MEM01CV04ANA MEM01CV04SSR	MEB0101	MER01	2.05 (52.1)	1.49 (37.9)	110 (27.9)	10-32 UNF	0.58 (14.7)	10-32 UNF	1/8 NPT
0.180 to 0.260 (4.6 to 6.6)	MES0102		MEB0102								
0.260 to 0.340 (6.6 to 8.6)	MES0103		MEB0103								
0.340 to 0.420 (8.6 to 10.7)	MES0104		MEB0104								
0.420 to 0.510 (10.7 to 13.0)	MES0105		MEB0105								

ME | Metric Mounting Holes and Pilot Ports

0.100 to 0.180 (2.5 to 4.6)	MES0101	MEM01 MEM01CV04ANA MEM01CV04SSR	MEB0101	MER01	2.05 (52.1)	1.49 (37.9)	110 (27.9)	M5	0.58 (14.7)	M5	1/8 BSPP (G)
0.180 to 0.260 (4.6 to 6.6)	MES0102		MEB0102								
0.260 to 0.340 (6.6 to 8.6)	MES0103		MEB0103								
0.340 to 0.420 (8.6 to 10.7)	MES0104		MEB0104								
0.420 to 0.510 (10.7 to 13.0)	MES0105		MEB0105								

Dimensions: inch (mm)

*Includes seals(s) and metal parts for one complete seal change.

***How To Add ICON™ to ME**

Signal Output	Part Number Suffix	Example
ME without ICON™	None	ME0101
ME with ICON™: Analog Output Signal	CV04ANA	ME0101 CV04ANA
ME with ICON™: Solid State Relay	CV04SSR	ME0101 CV04SSR



DON'T SEE A SOLUTION FOR YOUR APPLICATION? Submit a custom application form and drawing to fastsales@fastestinc.com or to your local distributor.