

OPERATING INSTRUCTIONS

GENERAL INFORMATION:

The **FX FasMate** is designed to provide a safe, reliable leak-tight seal and connection when properly maintained and used. Verify the connector seal mates well with the sealing surface. Make sure threaded test piece matches the threaded collets. Improper mating with a test piece can result in poor sealing, leakage and risk of connector failure resulting in damage or injury.

MAINTENANCE:

User must establish a regular interval for maintenance as determined by the user media and operational environment.

Periodically inspect the **FX Connector** and its seal for wear, damage and proper operation. Inspect also for lubrication needs or corrosion. Repair or replace as required to assure proper sealing, function, and safety.

Difficulty of operation indicates a need for inspection, lubrication, repair or other maintenance. Repair Kits are available.

WARNING



Use only factory authorized replacement seals and parts. Use of unauthorized parts/seals can cause failure resulting in damage or injury.

Parts and instructions available through **FasTest** or your **FasTest** distributor.

NOTE: Any field modification of **FasTest** connectors voids Factory warranty.

FasTest, Inc. Product Warranty

FasTest, Inc. warrants its products against defects of workmanship and/or material for 12 months from the date of the sale by FasTest, Inc. This warranty is void if the product is misused, tampered with or used in a manner that is not in accordance with FasTest, Inc. recommendations and/or instructions. FasTest, Inc. is not liable for consequential or other damages including, but not limited to, loss, damage, personal injury, or any other expense directly or indirectly arising from the use of or inability to use its products either separately or in combination with other products. ALL OTHER WARRANTIES EXPRESSED OR IMPLIED, WHETHER ORAL OR WRITTEN, INCLUDING BUT NOT LIMITED TO WARRANTIES OR MERCHANTABILITY OR FITNESS FOR A PARTICULAR PURPOSE ARE EXPRESSLY EXCLUDED.

Remedy under this warranty is limited to replacement of the product or an account credit in the amount of the original selling price, at the option of FasTest, Inc. All allegedly defective products must be returned prepaid transportation to FasTest, Inc. along with information describing the products performance, unless disposition in the field is authorized in writing by FasTest, Inc.

FX/FasMate Series

Description: Lever, Pneumatic & Thumb Valve Operated Connectors for Male Threads.

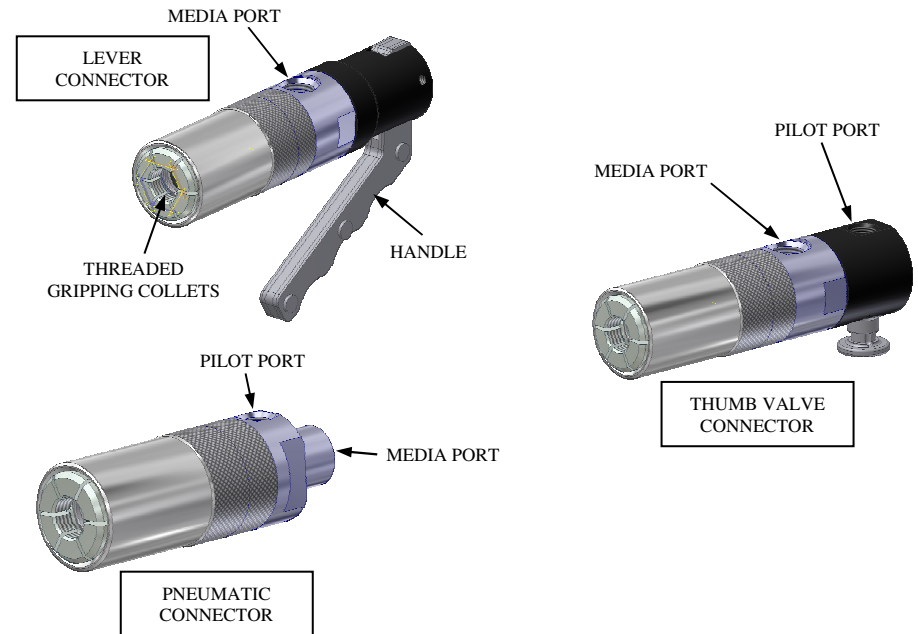

FX FasMate Connector provides a reliable leak-tight connection that grips and seals onto male threads.

Please thoroughly read and understand these operating instructions prior to operating connector. The use of pressurized media for sealing and testing requires a thorough understanding of the **FasTest FX FasMate** Operating Instructions.

- Operation
- General Information
- Maintenance
- Warranty

OPERATING INSTRUCTIONS

NOTE TO OPERATOR: Test Piece Connection Procedure.

1. **Lever, Pneumatic or Thumb Control.** Test piece must be pushed firmly against piston inside collets prior to releasing the Lever, Thumb Valve or Pneumatic pilot pressure.

2. ALWAYS MAKE SURE SLEEVE IS THREADED TIGHT TO BODY.

LEVER HANDLE OPERATION:

1. Squeeze the handle to extend/open the gripping collets of the connector. Push/place connector onto the male test threads until the main seal o-ring contacts the component to be tested.

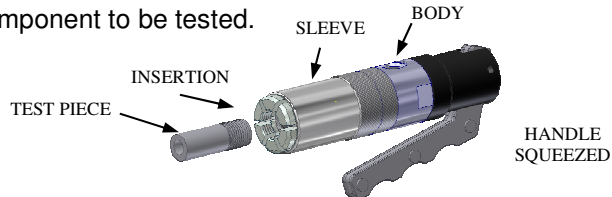

2. Release the handle of the connector, collapsing the collets to grip the test piece threads. Make sure collets have collapsed inside sleeve.

- Threaded collets grip onto male threads, drawing in the test piece to the sealing o-ring. Pressure into the media port completes the sealing process.

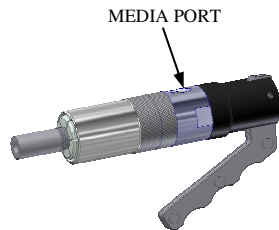

3. Introduce test media through media port for the duration of test.

4. When test is complete relieve test pressure and squeeze the handle to disengage connector from test piece.

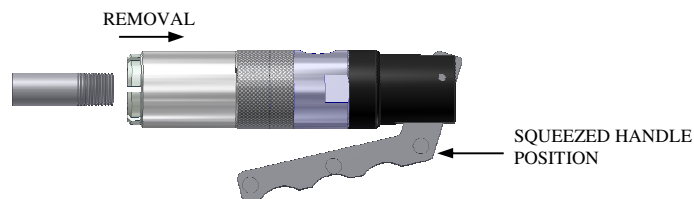

5. The previous four steps of connecting also apply to the operation of the Pneumatic and Thumb Valve operated connectors.
6. Both the Pneumatic and Thumb Valve connector require pilot port supply of 75-120 psi. Both styles have 1/8" NPT pilot ports.
7. **Pneumatic Valve Connector:** This requires external control provided by the user to engage and disengage the collets pneumatically.

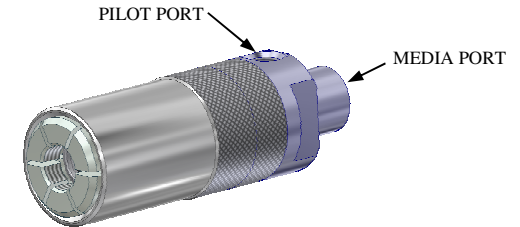

8. **Thumb Valve Connector:** Thumb Valve controls collet engagement by pressing the Thumb Valve on connector.

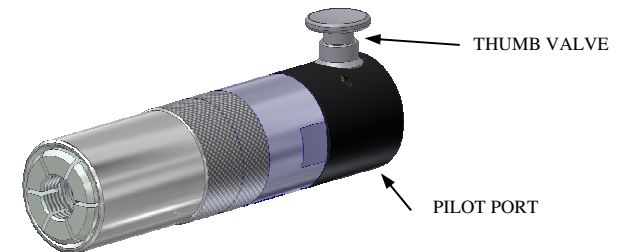

WARNING:

- **FastTest** Connectors are designed ONLY for the threads meeting the specifications listed in the **FastTest** literature. DO NOT use in other threads.
- Connectors are NOT designed for permanent connections and are for temporary connections only.
- DO NOT EXCEED pressure rating as marked on connector.
- Verify proper connection BEFORE pressurizing. Use only in a safe environment. Safety chains and guards are recommended for all applications.
- DO NOT move connector while under pressure. Damage or injury may result.