

INSTALLATION INSTRUCTION

XT[®] With SurConnect[™]

1. **Preparing the XT connector for SurConnect[™] installation-** Slide the sleeve of the XT connector back toward the termination end to expose the retaining ring. Using a pick or small screw driver, remove the retaining ring. Note: The retaining ring will be replaced.

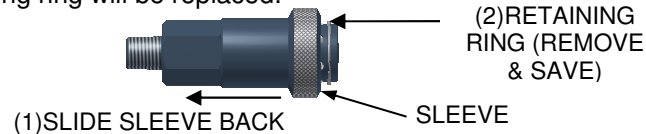

2. Once the retaining ring is removed, slide the sleeve forward enough to expose the sleeve latch o-ring (see step 3 illustration). Note: If the sleeve is removed all the way from the connector the latching balls may fall out of the connector.

3. Using a sharp Exacto knife or similar tool, cut the o-ring and remove.
Warning!!- Once the o-ring has been removed, the connector must not be used without the SurConnect[™] in place.

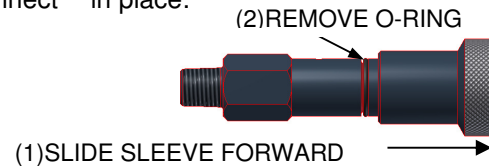

4. Slide the XT sleeve back into place. Place the retaining ring back onto the connector.

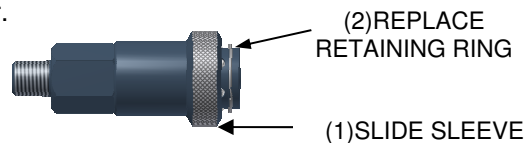

5. **Installing the SurConnect[™] kit-** Place the spring and the green ring over the outside of the connector. The recessed end of the green ring will face away from the knurled flange of the XT connector.

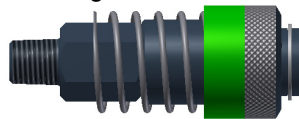

6. Slide the outer sleeve of the assembly over the spring and green ring.

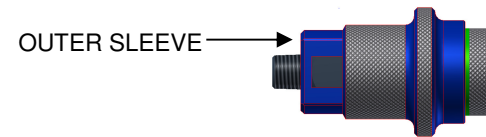

7. Place the o-ring over the NPT termination threads. (Note: This only pertains to kits supplied with the o-ring spacer).

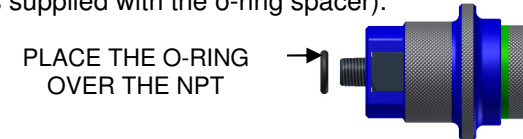

8. If the kit purchased has the SurConnect[™] assembled onto the XT connector without a process tip (Example part number XT12042SHR2), the vinyl cover on the npt fitting should be removed prior to torquing on the process tip or fitting.

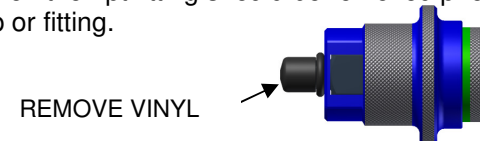

9. Apply the connection tip or fitting to the termination port of the connector. Thread sealant must be used. The connection tip will hold the assembly in place. Some space should remain (.020 MIN) between the fitting and the back of the sleeve. The SurConnect[™] must be able to spin to allow the flats of the XT connector to be accessible through the windows of the SurConnect[™]. Note: A recommended torque of 12 ft/lbs should be applied to the connection tip.

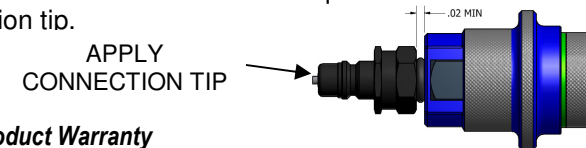

FasTest, Inc. Product Warranty

FasTest, Inc. warrants its products against defects of workmanship and/or material for 12 months from the date of the sale by FasTest, Inc. This warranty is void if the product is misused, tampered with or used in a manner that is not in accordance with FasTest, Inc. recommendations and/or instructions. FasTest, Inc. is not liable for consequential or other damages including, but not limited to, loss, damage, personal injury, or any other expense directly or indirectly arising from the use of or inability to use its products either separately or in combination with other products. ALL OTHER WARRANTIES EXPRESSED OR IMPLIED, WHETHER ORAL OR WRITTEN, INCLUDING BUT NOT LIMITED TO WARRANTIES OF MERCHANTABILITY OR FITNESS FOR A PARTICULAR PURPOSE ARE EXPRESSLY EXCLUDED.

Remedy under this warranty is limited to replacement of the product or an account credit in the amount of the original selling price, at the option of FasTest, Inc. All allegedly defective products must be returned prepaid transportation to FasTest, Inc. along with information describing the products performance, unless disposition in the field is authorized in writing by FasTest, Inc.

WARNING: Do not operate an XT connector that has been modified for operation with SurConnect[™]. The XT connector without the SurConnect[™] in place could result in unintended disconnection.