

OPERATING INSTRUCTIONS

RPV Pin Removal and Installation

DESCRIPTION:

Residual pressure valve (RPV) pin removal, installation, and maintenance on compressed gas connectors.

REMOVAL:

- 1) Using the RPV pin tool (p/n G580RPVPT), retract the RPV pin if it is not already. Push pin in and turn 90 degrees.
 - a. If not using the RPV pin tool, you do not need to retract the pin, and may want the pin extended. Use pliers.

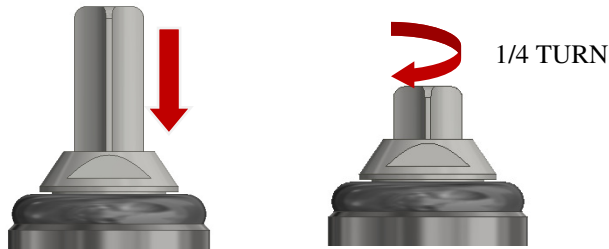

- 2) Using an adjustable wrench or G580RPVPT, remove the piston nut by turning counterclockwise. G580PT has two sides, the large one for G580 connectors, and the smaller one for G540 connectors.

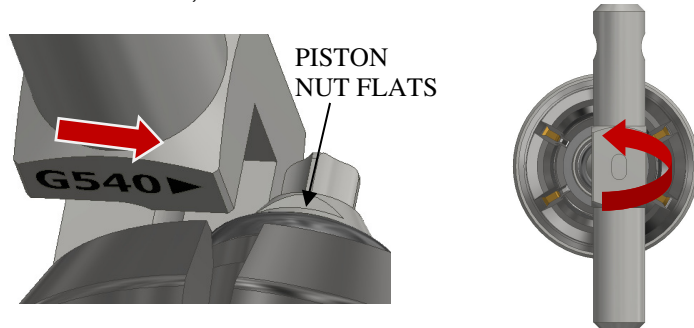

FasTest, Inc. Product Warranty

FasTest, Inc. warrants its products against defects of workmanship and/or material for 12 months from the date of the sale by FasTest, Inc. This warranty is void if the product is misused, tampered with or used in a manner that is not in accordance with FasTest, Inc. recommendations and/or instructions. FasTest, Inc. is not liable for consequential or other damages including, but not limited to, loss, damage, personal injury, or any other expense directly or indirectly arising from the use of or inability to use its products either separately or in combination with other products. ALL OTHER WARRANTIES EXPRESSED OR IMPLIED, WHETHER ORAL OR WRITTEN, INCLUDING BUT NOT LIMITED TO WARRANTIES OR MERCHANTABILITY OR FITNESS FOR A PARTICULAR PURPOSE ARE EXPRESSLY EXCLUDED.

Remedy under this warranty is limited to replacement of the product or an account credit in the amount of the original selling price, at the option on FasTest, Inc. All allegedly defective products must be returned prepaid transportation to FasTest, Inc. along with information describing the products performance, unless disposition in the field is authorized in writing by FasTest, Inc.

- 3) Remove pin, spring, and o-ring once top nut is removed. Take care as contents are spring loaded when pin is retracted. Discard only the parts you are replacing. It is recommended to replace the spring and o-ring along with the pin.

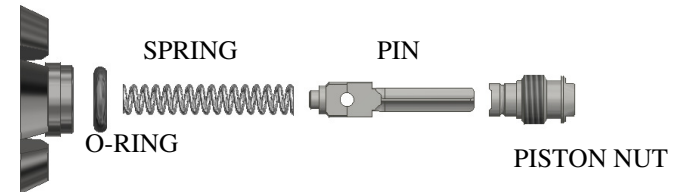

INSTALLATION:

- 1) Insert spring into piston bore, followed by pin and piston nut.
- 2) Using an adjustable wrench or G580RPVPT, tighten the piston nut. Do not over tighten. Damage to nut may occur.
- 3) *G540 ONLY* It is recommended to use torque tool (p/n G540RPVTK), which is set at 35 in-lb (4 N-m) to tighten nut.
- 4) Install o-ring between piston and piston top nut. Installation completed.

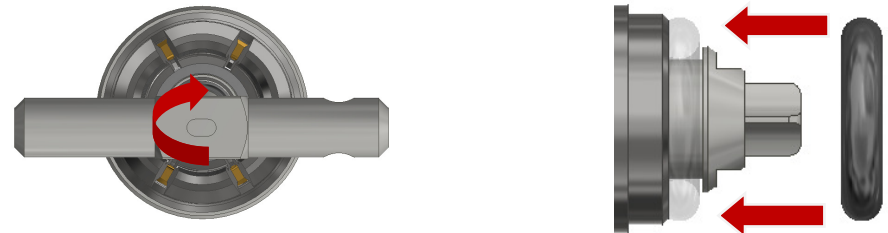

MAINTENANCE:

- 1) Check weekly to ensure nut is seated and torqued properly. Use adjustable wrench, G580RPVPT, or for G540 connectors use G540RPVTK.